



## DAVITS (1)

- Removable Davits  
– Mounting Hardware
- Rotating Davits  
– Mounting Hardware
- Davit Lifting Accessories

## TIPUP DAVITS (9)

- St. Croix System
- Special System for Walker Bay

## MOTOR TIPPER (12)

## PLATFORM ROLL-ON SYSTEMS (13)

- Hard Bottom Inflatables
- Personal Watercraft
- Long Bunk

## TOWBAR SYSTEM (16)

## FOLDING LADDER (16)

## EURO HELM & SEATING (17)

## CRANES (18)

- Crane Accessories  
– Spare Mounting Kit  
– Outboard Motor Bracket

With their tradition of nautical excellence, St. Croix Marine Products deserve serious consideration from those who demand premium quality for every boating dollar invested. Each major St. Croix component is crafted from stainless steel and polished to attract envious attention in any marina.

To assure your utmost satisfaction, St. Croix offers over a dozen different components from which you can assemble a total system customized for your specific boating requirements.

# 2011



MARINE  
PRODUCTS

TEL: 612/724-9361  
FAX: 612/724-9362  
www.davit.com



Models  
250 & 300



Model  
500

# ST. CROIX REMOVABLE DAVITS

**MODEL 250**  
**MODEL 300**  
**MODEL 500**

Quality, Design and Ease of Use make St. Croix Removable Davits the choice of discriminating boaters. They let you launch your tender and then just seconds later have your swim platform and stern completely clear and ready for use. Simply pull the locking pin on each arm and slide it out of the permanently mounted shoe. It's that easy!

Notice how we've integrated the upper pulley as a

structural component?

This unique feature adds strength and prevents twisted lifting lines.

Engineered for the marine environment, the tubular 316 stainless steel davits are mirror polished for a lasting finish. Choose from three models to attain the right combination of lifting capacity, lifting ratio and davit arm reach for your specific needs.

Models #250 & #300 are rated for 350 lbs. (158 kg) per pair and will carry a 10 or 11 ft. inflatable with up to a 15 hp motor.

Model #500 is rated for 480 lbs. (218 kg) and will carry heavier loads at greater speeds. When figuring the weight of your tender, all items (i.e. full gas tank, equipment, motor & seating) must be included.

Each davit system includes:

- 2 Davit Arms
- 2 Mounting Shoes
- 2 Integrated Upper Pulleys
- 2 Lower Pulleys
- 2 Hooks
- 2 Integrated Cleats
- 2 Lock Pins
- Model 500 also includes 50 ft. (15.2 m) lifting lines

*The very best installations use the proper lifting accessories and mounting hardware. Our full line of lifting accessories will help complete your davit system, assuring you ease of use and safety for years to come.*

## Models 250 & 300

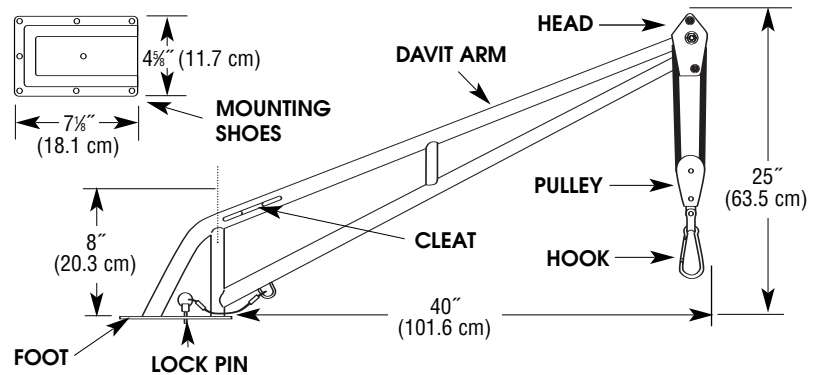

## Model 500

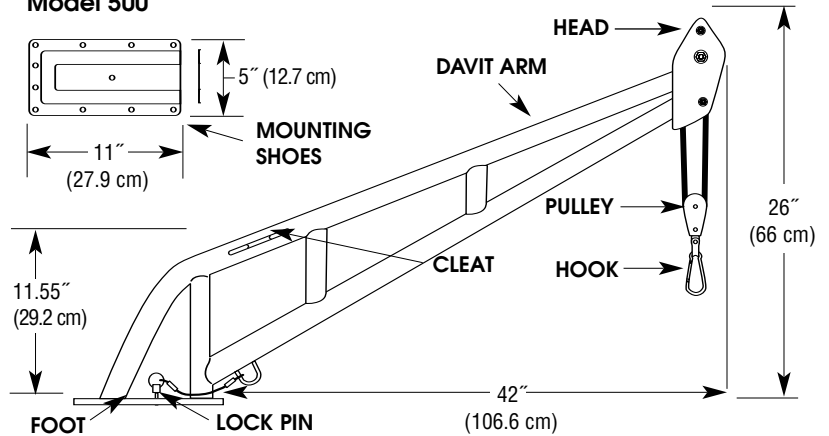

Davit Model Number	Davit Lifting Ratio	Lifting Line Diameter	Davit Arm Reach	Davit Tube Dia.	Mounting Shoe Dimensions (Length & Width)	Recommended Weight Lifted Per Pair
250	7:1	5/16"	40" (101.6 cm)	1" (25 mm)	7 1/8" x 4 5/8" (18.1 x 11.7 cm)	Up to 225 lbs* (102 kg)
300	9:1	5/16"	40" (101.6 cm)	1" (25 mm)	7 1/8" x 4 5/8" (18.1 x 11.7 cm)	Up to 350 lbs (159 kg)
500	9:1	3/8"	42" (106.6 cm)	1 1/2" (37.5 mm)	11" x 5" (27.9 x 12.7 cm)	Up to 480 lbs (218 kg)

\* Model 250 is rated to lift 350 lbs. (158 kg.). However at over 225 lbs. it's 7:1 lifting ratio begins to make the line pull more difficult for the average person.



## MOUNTING HARDWARE FOR MODELS 250, 300 & 500 REMOVABLE DAVITS

The design of some boats may require the use of additional mounting hardware. Our full line of mounting hardware is fabricated from stainless steel and designed to install with ease assuring you of a safe installation and years of comfortable use.

### CUSTOM MOUNTS

Model 209 & Model 509

- Mounts Inside or Outside of Transom
- Call Factory for Ordering Details (952.858.8393)
- Model 209 For Use With 250 & 300 Series Davits
- Model 509 For Use With 500 Series Removable Davits

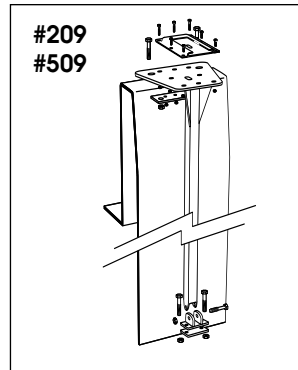

### SPORTFISH MOUNT

Model 208 & Model 508 - Internal supports for sportfish boats when the coaming surface is unsupported. This is a requirement on most sportfish style boats. It looks like an inverted tripod.

- Model 208 for use with 250 & 300 Series Removable Davits
- Model 508 for use with 500 Series Davits

*Customer must notify the factory of dimension "A".*

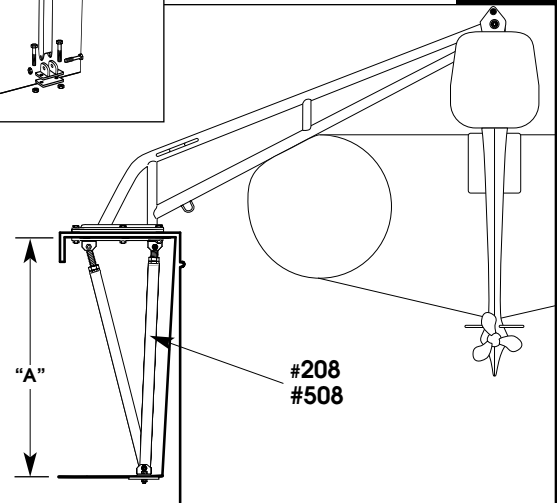
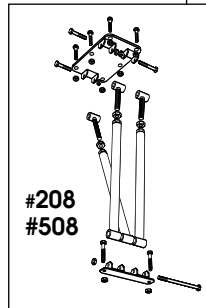

### 6" RISER Model 211

**12" RISER Model 212** - These stainless steel forms are used on boats that require additional height. **Their use will increase the leverage of the davits on the boat and limits the davits capacity to 200 lbs.** Use of a compression plate is recommended under the riser. Drilled for 1/4" bolts.

- Models 210, 211, 212, and 213 are for use with 250 & 300 Series Removable Davits
- Models 511 & 512 are for use with 500 Series Davits

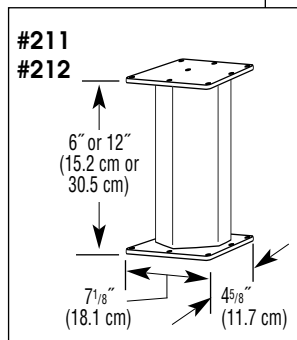

#211 6" (15.2 cm) RISER  
#212 12" (30.5 cm) RISER

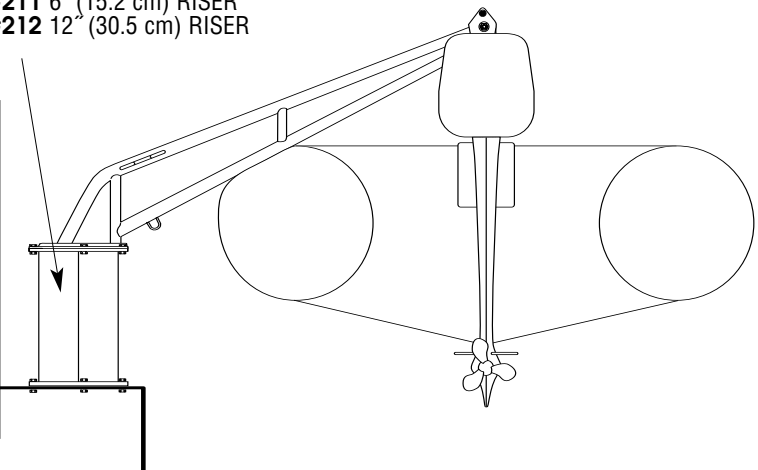

### 6" RISER Model 210

**12" RISER Model 213**  
SS removable riser gives added height when needed. Use with #250 & 300 Series Davits only.

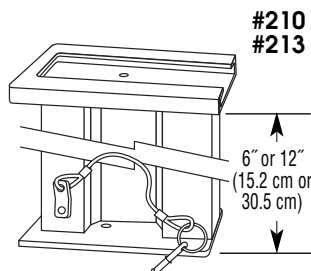

#210  
#213

### 6" RISER Model 511

**12" RISER Model 512**  
SS removable riser gives added height when needed. Use with #500 Series Davits only.

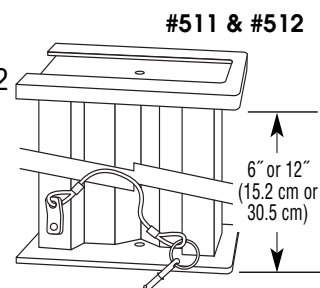

#511 & #512

### COMPRESSION PLATES

Model 214 & Model 514 - Stainless steel plates in a trapezoidal shape pre-drilled with the shoe bolt pattern. Use these plates on boats that have teak covering boards or where the mounting surface is cored. These are required on all Searays that have an integrated swim platform. They provide a larger footprint for the davit to push on. Drilled for 1/4" bolts.

- Model 214 for use with 250 & 300 Series Removable Davits
- Model 514 for use with 500 Series Removable Davits

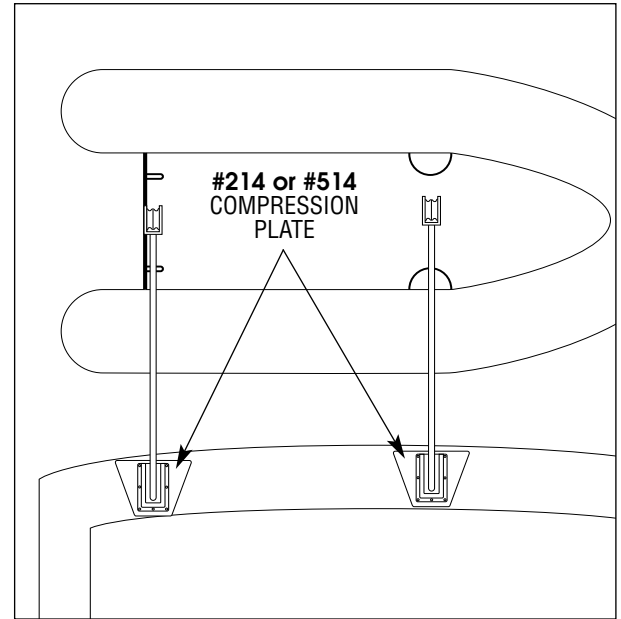
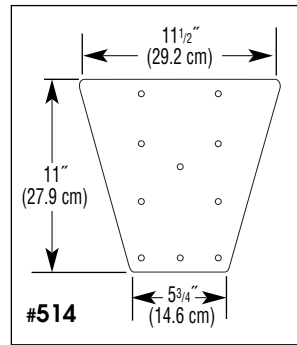
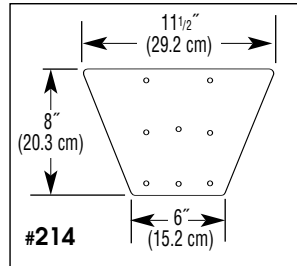

### Backing Bars For Removable Davits

In some applications where Model 250, 300 or 500 Removable Davits are used, additional support must be added to the swim platform. These heavy-gauge aluminum channels mount under the platform and provide that support. (See drawing below.)

Model 206 for use with 250 and 300 Series Davits

Model 506 for use with 500 Series Davits

Note: Shoes shown in drawing come with davits. Thus they aren't provided with backing bars.

\*Use Model 214 or 514 Compression Plates for additional strength.

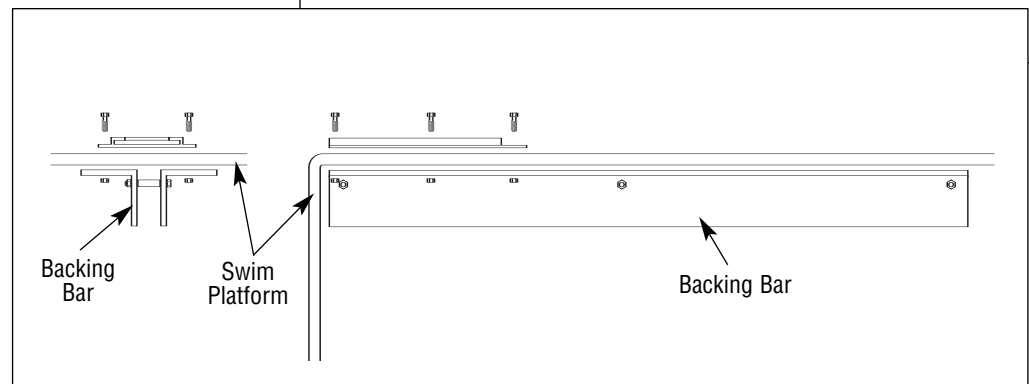
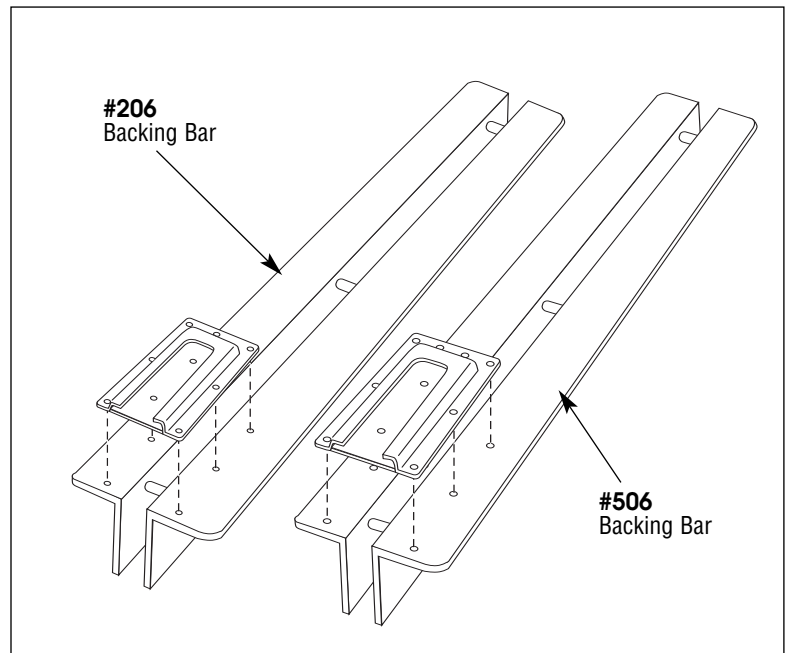



# ST. CROIX ROTATING DAVITS

**MODEL 400  
MODEL 488**

Engineered and designed for years of salt or fresh water use, St. Croix Rotating Davits are for boaters who need a rotating davit system. Ideal for sail and power boats, the 316 tubular stainless steel Rotating Davits incorporate a fixed upper block welded as a structural component of the arm. It multiplies davit strength and prevent twisted lifting lines. Unique to these davits is the optional Platform Mount (#401) that allows them to be mounted on an extended swim platform. When not in use, the davits rotate or fold together.

Ball and socket lower mounts coupled with "free-rotation" upper rail brackets, minimize stress under any sailing conditions. The upper mount is a clamshell that attaches to either a stern rail or a vertical surface. The davits rotate in the clamshell. Its oval holes provide 12° of adjustment to compensate for non-square applications. The ball and socket lower mount is adjustable and will pivot up to 26°.

Model #400 is 1" (25mm) tubular stainless steel and rated to lift 300 lbs. (136kg) per pair with a 9:1 lifting ratio.

Model #488 is 1-1/4" (32mm) tubular stainless steel and rated to lift #488 lbs. (222kg) with a 9:1 lifting ratio.



Each davit system includes:

- 2 Davit Arms
- 2 Hooks
- 2 Lower Pulleys
- 2 Lower Ball Joints
- 2 Integrated Upper Pulleys
- 2 Integrated Cleats
- 2 Upper Clamshell Mounts for 1" (25mm) rails
- Model #488 includes 50 ft. (15.2 m) lifting lines

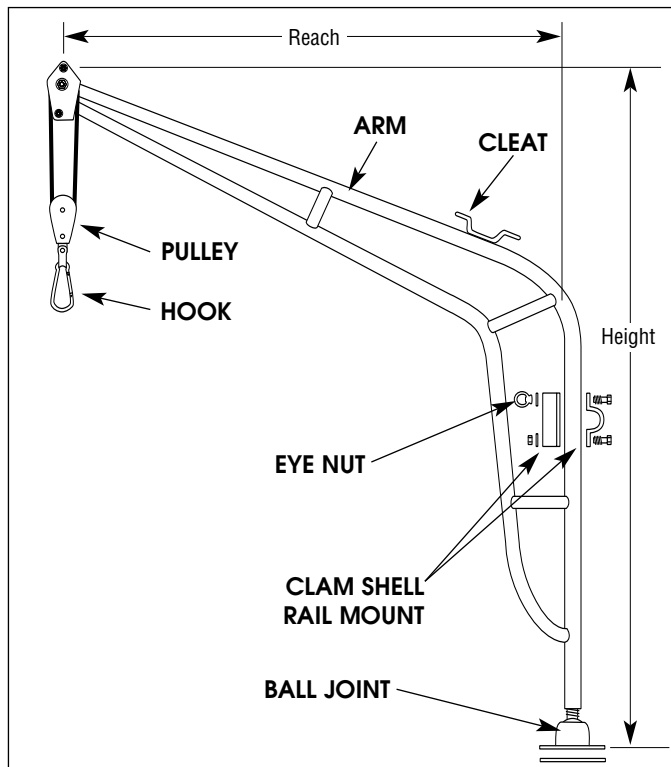

*The very best installations use the proper lifting accessories and mounting hardware. Our full line of lifting accessories will help complete your davit system, assuring you ease of use and safety for years to come.*

Model Number	Davit Lifting Ratio	Davit Arm Reach	Davit Arm Height	Ball & Socket Lower Mount	Weight Rating Per Pair	Davit Tube Dia.	Lifting Line Dia.
400	9:1	40" (101.6 cm)	60" (152.4 cm)	3" x 3" (7.6 x 7.6 cm)	300 lbs. (136 kg)	1" (25 mm)	5/16"
488	9:1	41" (104.4 cm)	60" (152.4 cm)	3" x 3" (7.6 x 7.6 cm)	488 lbs. (222 kg)	1 1/4" (31.75 mm)	3/8"

## MOUNTING HARDWARE FOR MODELS 400 & 488 ROTATING DAVITS

Some boats' designs may require the use of additional mounting hardware. Our full line of mounting hardware is fabricated from stainless steel and designed for easy installation that assures you years of safe, comfortable use. Unique to the St. Croix Rotating System is our optional Platform Mount (#401) designed for boats with extended swim platforms. This mount creates the rail needed to install the davits while preserving the swim platform for use while the tender is in the water.

### PLATFORM MOUNT

Model 401 - The platform mount is a tubular stainless steel rail that allows mounting of the Rotating Davits on an extended swim platform. The platform mount bolts to the stern of the swim platform creating the rail needed to install the davits.

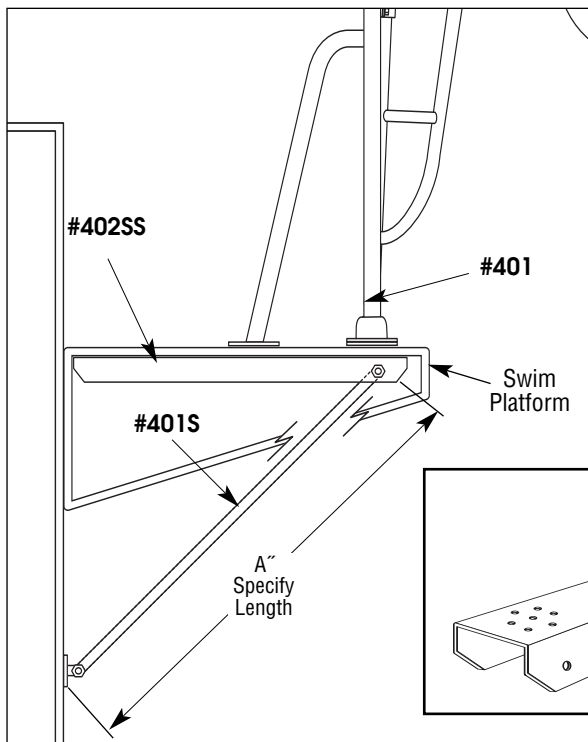
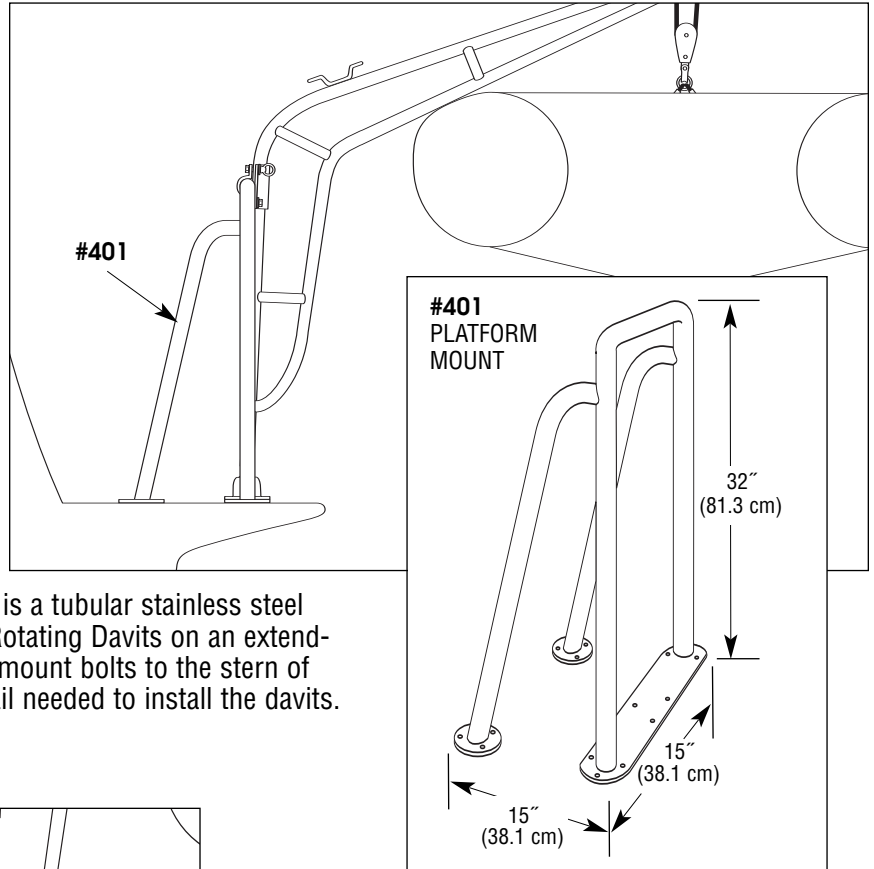

### BACKING BARS FOR THE 401 PLATFORM MOUNTS

In some 401 Rotating Davit applications, extra support must be added to the swim platform. The combination of a #402SS channel and a #401S brace bar provides that support. (See drawing left.) Both components are fabricated from stainless steel.

Note: When additional support is required, you need a 402SS AND a 401S for each davit.

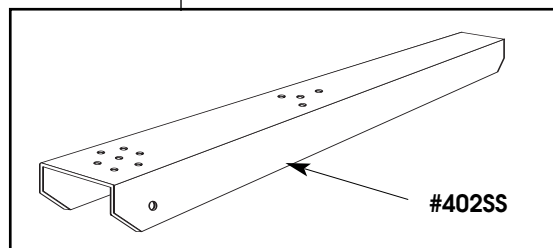

## REMOVABLE PLATFORM MOUNTS

Model 404 - This is an ideal mounting system for boats with extended swim platforms. After your dinghy is launched, you can remove and store Model 404 mounting system in just seconds. Just loosen two bolts, pull the pins, fold it up and you're done. (The low profile 3" x 3" and 5" x 17" mounting plates stay in place.)

Like all our Rotating Davit mounting accessories, the Removable Platform Mount features rugged, stainless tubular steel construction backed by St. Croix's long-held reputation for nautical excellence.

## BACKING BARS FOR THE 404 REMOVABLE PLATFORM MOUNTS

In some applications a Model 404 installation the swim platform requires additional support for each davit. The combination of a #403 channel and a #401S brace provides that support. (See drawings below.) Both components are fabricated from stainless steel.

Note: When additional support is required, you need a Model 403 channel and a 401S support bar for each davit.

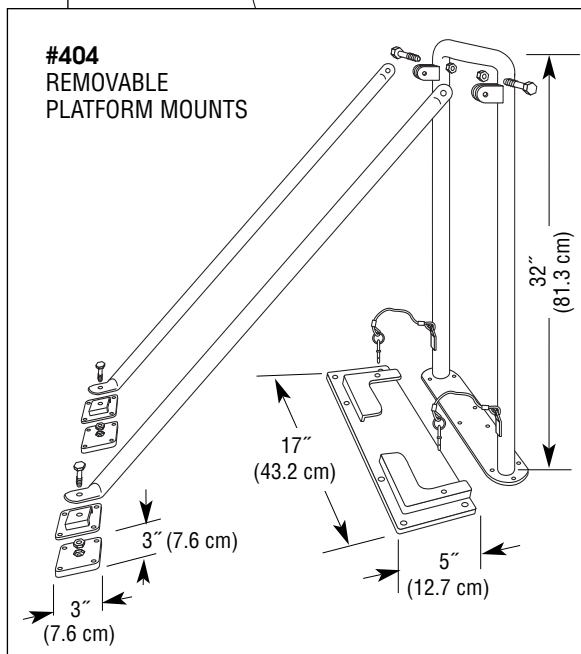
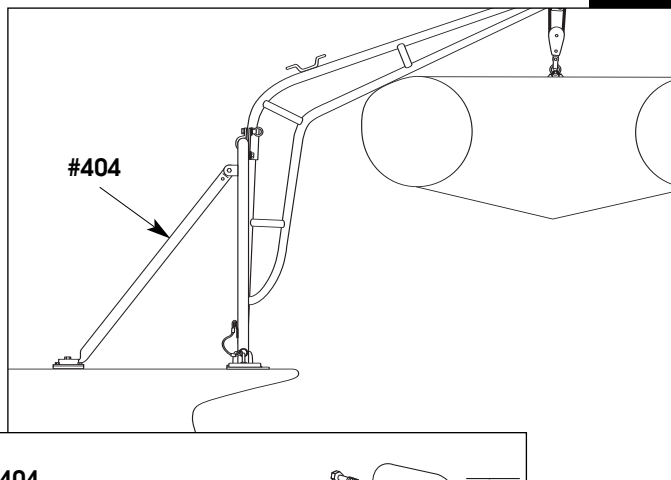

See next page for More Mounting Hardware.

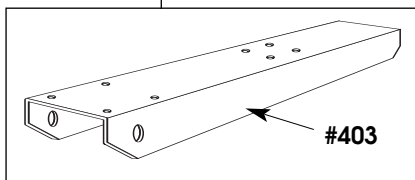
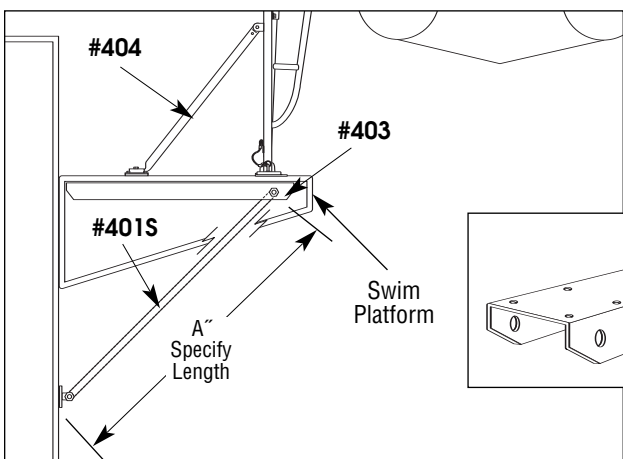

## Model 430 Removable Mount Kit for 400 & 488 Rotating Davits

If your stern is configured as shown in the drawing on the far right, Model 400 and 488 Rotating Davits can be installed as easily-removable components. Just pull one pin from the 403s horizontal shoe mount. Then the davit can be turned and lifted out of the base plate.

All 403 components are made from polished stainless steel.

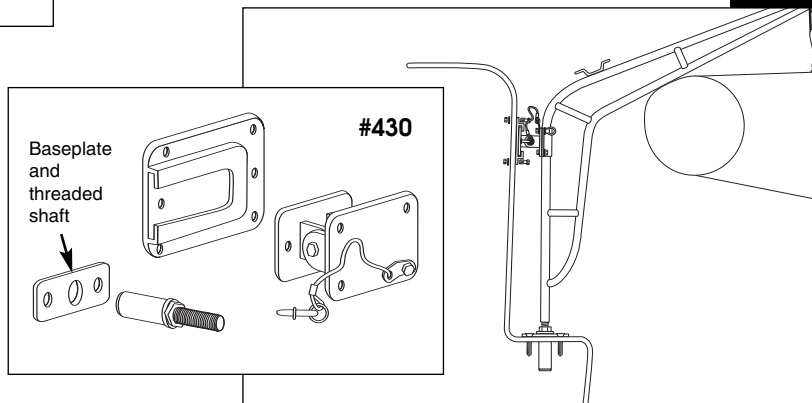

## MOUNTING HARDWARE FOR MODELS 400 & 488 ROTATING DAVITS

### TRANSOM MOUNT

Model 414 - This stainless steel angle mount will allow the mounting of the davits to a vertical surface. The lower ball joint bolts to the top of the mount.

**Note:** Specify incline angle and factory will form at no additional cost. If no angle specified, comes from factory at 90°.

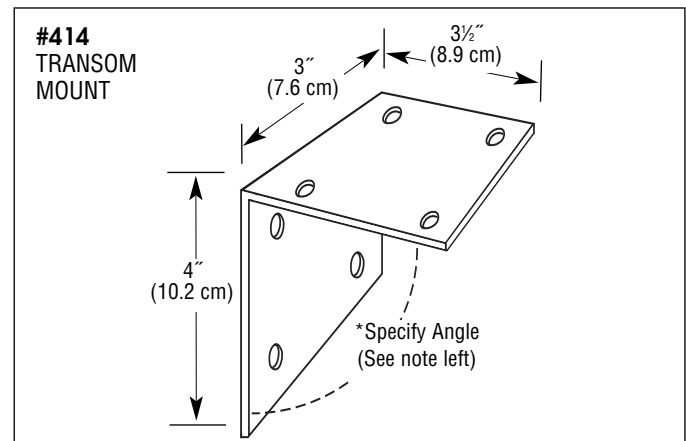

### TRANSOM HANDLES

Model 415 - This stainless steel tubular design let you maintain true vertical when our Rotating Davits are mounted on sterns configured as illustrated. When used with our Model 412 Clamshells, this elegantly simple solution is easy to install.

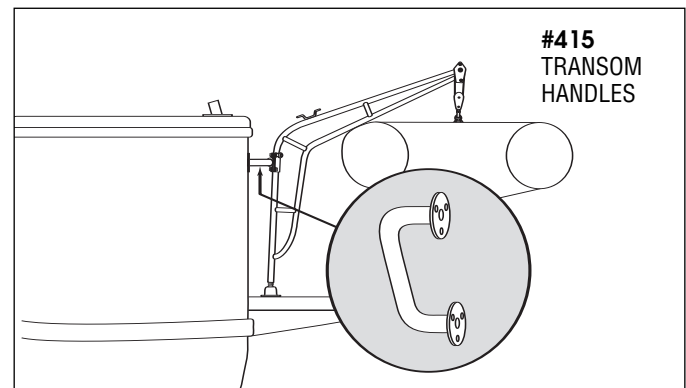

### ANGLED TRANSOM HANDLES

Model 417 - If yours is one with a transom that's not really high enough to use our Model 415 Transom Handles, this angled design should do the trick. It has the same durable stainless steel tubular construction; but with their upward tilt, each allows the clamshells to connect high on the davit. You get greater stability and a more attractive finished installation.

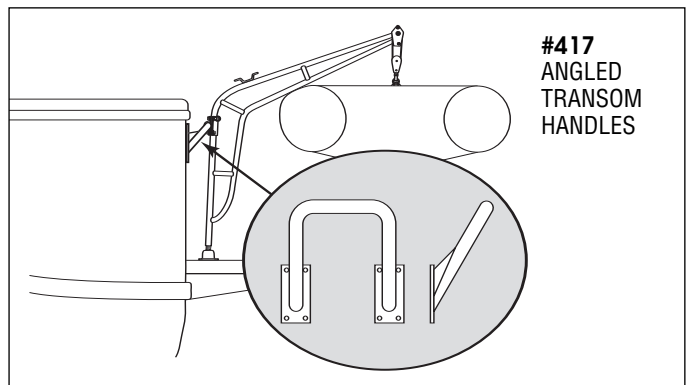

### CORNER SEAT MOUNTS

Model 416 - Installing any davits on Hunter, Catalina and other craft with similar designs can prove a real challenge. However, St. Croix's Model 416 Corner Seat Mounts are an aesthetically pleasing solution that are easy to employ.

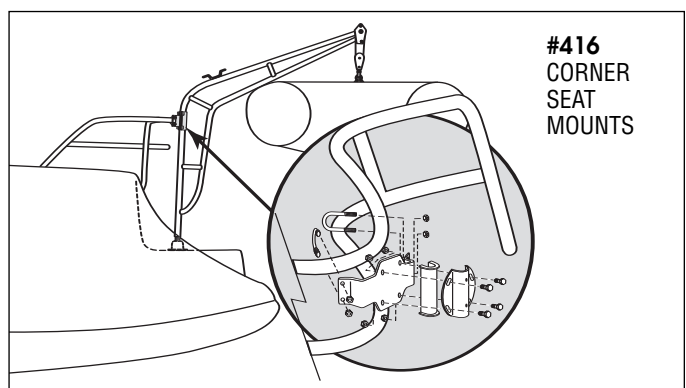



## DAVIT LIFTING ACCESSORIES

### FRONT LIFTING POINTS

Model 221 - 2 thru-hull eye bolts used for bow lifting points in RIBs only.

### HYPALON "D" RING KIT - Model 222

### PVC "D" RING KIT - Model 223

Two "D" ring patches that are glued to the inside of the inflatable tube in the bow area and used to attach the lifting sling (glue not included).

### TWO POINT EYE BOLT KIT

Model 219 - Two eye bolts that are mounted in the transom of the inflatable as a place to attach the lifting sling. Comes with 2 additional eye nuts that go on the outside of the transom. One of the eye nuts is used to attach the tie down restraints to the inflatable.

### STAINLESS STEEL LIFTING YOKE

Model 220 - This unique mount eliminates the need for separate lifting straps on the transom. The yoke mounts below the motor and does not interfere with its operation. Just 7.5" (19.1 cm) from transom to eyebolt.

### LIFTING LINES

Models 231 (2 x 50'), 232 (2 x 75'), and 233 (2 x 100') - Two pieces of 5/16" double braid line. Lines attach to the bottom bolt at the head of the arm using a bowline knot. Use with models 250, 300 & 400 davits only.

### LIFTING SLINGS

Models 234, 235, 236, 237, 238 - Stainless steel lifting slings that are available in a variety of lengths. Slings are used to attached the dinghy to lower pulley of the davits.

### HAND WINCH

Model 240 - Attaches to the davit arm with rail fittings. No drilling required. Provides an additional 6:1 power advantage to lift a heavy boat with even greater ease. Includes a removable floating handle and rail fittings.

### STAINLESS STEEL RATCHET TIE DOWN RESTRAINTS - Model 242

These straps allow you to secure your inflatable to the davit arms to prevent any movement while you are underway. Made of black nylon web strap and all stainless steel hardware. Length is 5' (1.53 m).

#221

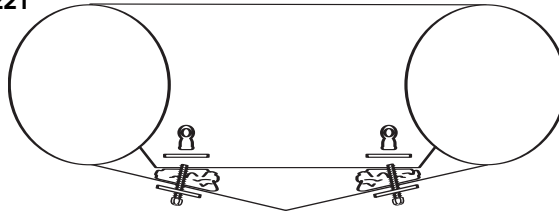

#222

HYPALON  
"D" RING KIT

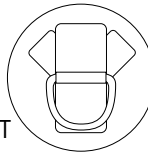

#223

PVC "D" RING KIT

#219

TWO POINT  
EYEBOLT KIT

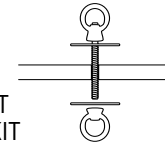

#220

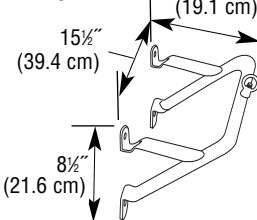

#220  
LIFTING  
YOKE

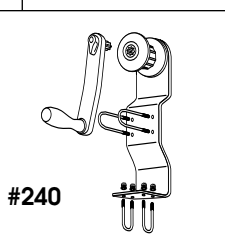
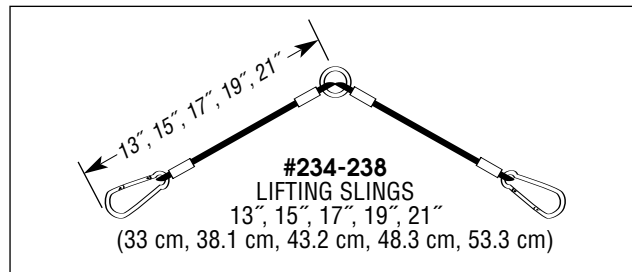

#240

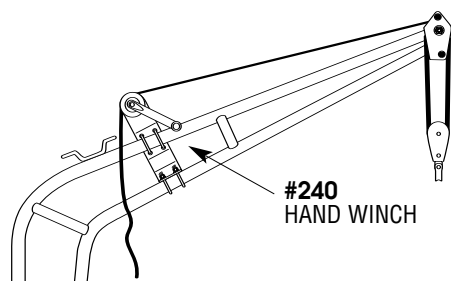

#240  
HAND WINCH

#242  
STAINLESS  
STEEL RATCHET  
TIE DOWN  
RESTRAINTS

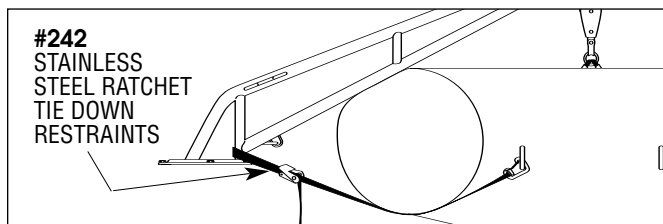



**Bow Lifting Arm**  
Model 913 shown here, others similar.

*The above photo shows optional Stand-Off bars that are not included with TipUp Systems. Saltwater applications? Be sure to see our Motor Tipper on back page.*



**Transom Lifting Arm**  
Model 913 shown here, others similar.



**Rolling Locks**

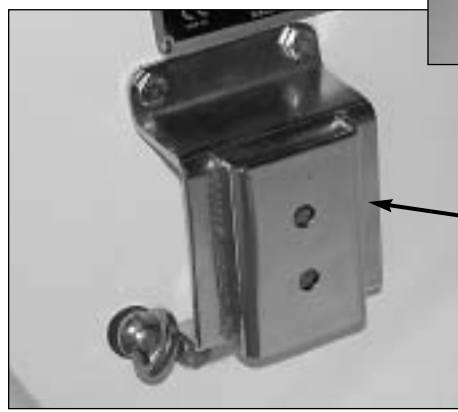

**Transom Mounting Socket**

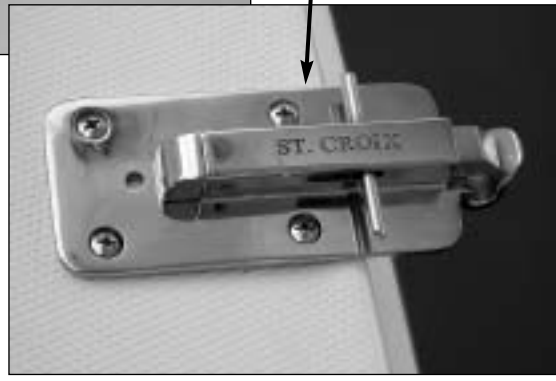

**Platform Snap-Latch**

# ST. CROIX TIPUP SYSTEM

## MODELS 911, 912, 913

With St. Croix's TipUp Davits nothing touches the dinghy tube because the system installs without glue! Polished 304 & 316 stainless steel davits are custom fit for swim platforms up to 24" (61 cm) high. Once stowed, dinghy can't be buffeted by the water. Optional accessories give you the perfect installation for your particular craft. The system removes easily without tools.

Rated For Up To 450 lbs. (204 kg) Per Pair

### Swim Platform Height Determines Which TipUp System You Need

Platform Height	Bow	Transom	Model#
6"-12" (15.2 cm - 30.5 cm)			#911
12"-16" (30.5 cm - 40.6 cm)			#912
16"-24" (40.6 cm - 61 cm)			#913

All Systems Include: 1 Transom Mounting Socket, 2 Rolling Lock Bow Sockets, 2 Platform Snap-Latches, 1 Bow Lifting Arm, 1 Transom Lifting Arm and Fasteners.

## ST. CROIX TIPUP SYSTEM OPTIONAL ACCESSORIES

(See back page for **Motor Tipper** Option.)

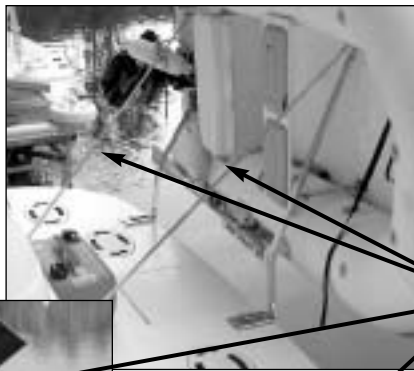

#932 5' (1.5 m) Lifting Strap



**Stand-Off Bar Kits**  
(includes bar and mounts)

- #926 12" (30.5 cm) Stand-Off Bar Kits
- #927 20" (50.8 cm) Stand-Off Bar Kits
- #928 28" (71.1 cm) Stand-Off Bar Kits
- #929 36" (91.4 cm) Stand-Off Bar Kits
- #930 44" (111.8 cm) Stand-Off Bar Kits
- #931 52" (132.1 cm) Stand-Off Bar Kits

#914 Shoe Kit

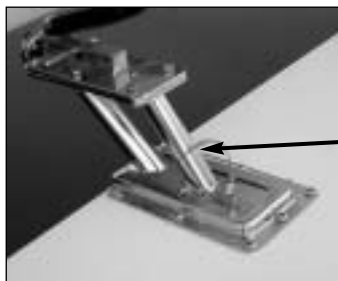

#934 4"x 4"  
(10.2 cm x 10.2 cm) Extension  
(latch and mounting shoe not included)

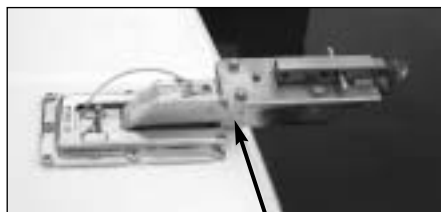

#935 6" (15.2 cm) Horizontal Extension  
(latch and mounting shoe not included)

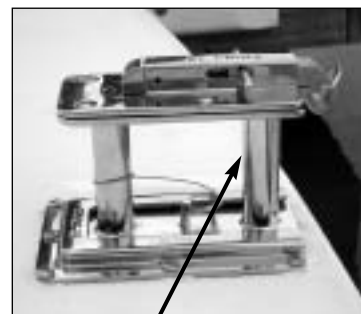

#936 4" (10.2 cm) Riser  
(latch and mounting shoe not included)



# ST. CROIX WALKER BAY TIPUP SYSTEM

**MODELS 908 & 909**

These are the perfect retrofit systems for 8' or 9' Walker Bay tenders. They bolt to the boat using holes already in the seat and transom channel.

Stand off rods hold the tender steady while under way. To launch, just lay the tender down in the water and disconnect from the snap latches that are bolted to the swim platform. No tools are required!

The complete system is engineered with satin finished stainless steel for years of trouble-free service.

**#908 & #909 Walker Bay Tip-Up kit**

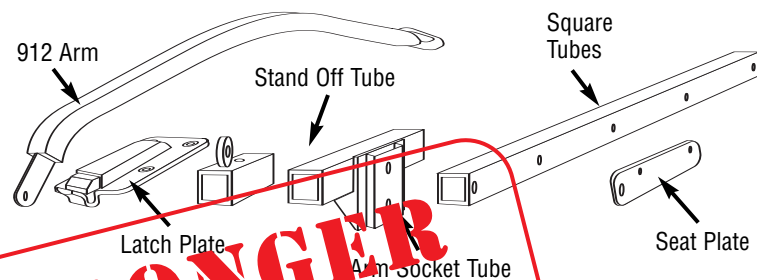

**NO LONGER AVAILABLE**

# WALKER BAY LIFT SYSTEM

**MODELS 906 & 907**

**#906 & #907 Walker Bay Lift**

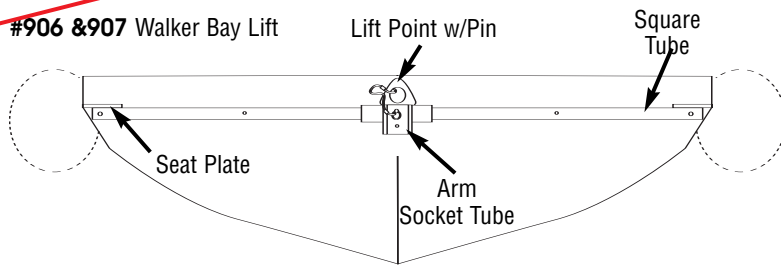

For captains who prefer davits, the unique seat-mounting hardware used in our Walker Bay TipUp system can be used for davits. In these cases a centered lifting point is supplied for the square transom tube.

**#909 Walker Bay Lift kit**

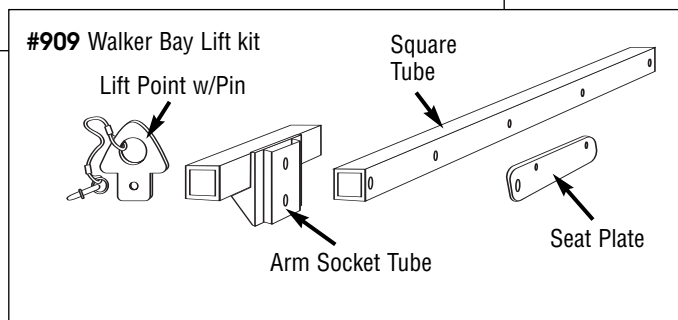

# ST. CROIX MOTOR TIPPER

**MODEL 950 - Port Tube Down**

**MODEL 951 - Starboard Tube Down**



Never again do you have to disconnect everything and heave your motor up on deck when you want to get underway. In just 30 seconds the St. Croix Motor Tipper lets you reposition your outboard so the powerhead stays above the propeller (saltwater-free) when the dingy is tipped upright.

Its pivoting motor plate is pre-drilled to index with bolt patterns on the most popular 2- and 4-cycle Evinrude, Johnson, Mercury, Honda, Yamaha, and Nissan outboards. Engineered to handle up to 120 lbs., the Motor Tipper can be mounted on transoms up to 1-3/8" thick that are flat on the outside. In many cases, this means you'll need to remove the transom's existing motor wear and clamping plates. If there is a flange on top of the transom, it must go too. But once installed, this highly polished stainless steel timesaver will give you a lifetime of trouble-free service.

## Tipper Specifications:

- Height - 11" (27.9 cm)
- Width - 15 1/2" (39.4 cm)
- Depth - 3" (7.6 cm)
- Weight - 24 lbs. (10.9 kg)
- Transom - Not Over 1 3/8" (3.49 cm) Thick
- Capacity - 120 lbs. (54.4 kg)

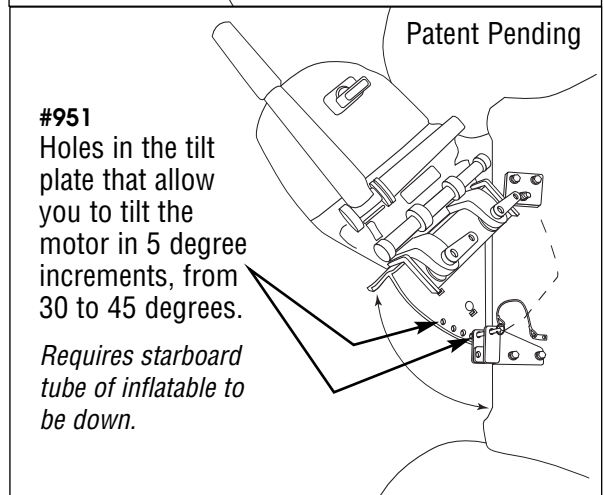
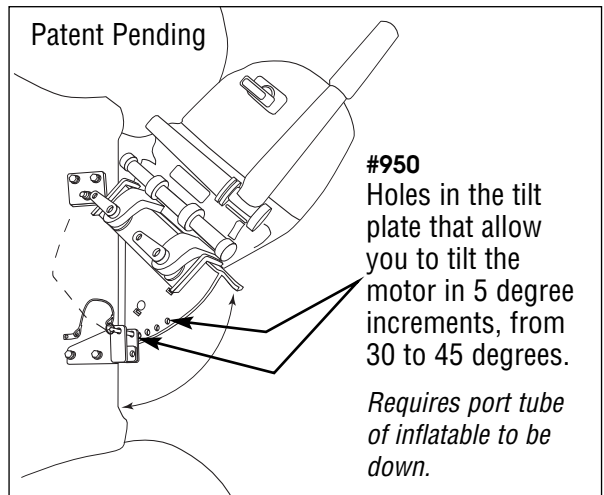

# ST. CROIX ROLL-ON SYSTEM FOR HARD BOTTOM INFLATABLES

## MODEL 840

Patent #10/306,189

This is the newest addition to our long line of dinghy storage systems. If your platform has at least 42" of depth, this model is probably best for your vessel. Designed for hard bottom inflatables up to 1000 lbs (454 kg.), each of its three independent roller assemblies can be positioned exactly where they will best accommodate your dinghy. The outriggers on each are equally adjustable.

Once set up, the system is very simple. Just winch the dinghy up and over the tilting lead roller – and then onto the cradle rollers. Then attach your tiedown straps and slide the lead roller and winch out of their shoes.

When not needed you clear the platform by popping out the ball detent lock pins on each roller assembly. This takes less than 30 seconds and requires no tools whatsoever.

Mounting fasteners for shoes and deck inserts are not included.

The components of the system include:

- Mounting shoe (1)
- Tilting lead roller section that slides into the shoe (1)
- Flush mounted deck inserts (3)
- Main assembly that fits into the deck inserts (3)
- 1" (25 mm) SS ratchet straps (3)
- Pad eyes for securing the tender (3)
- Includes winch with brake (shown below)

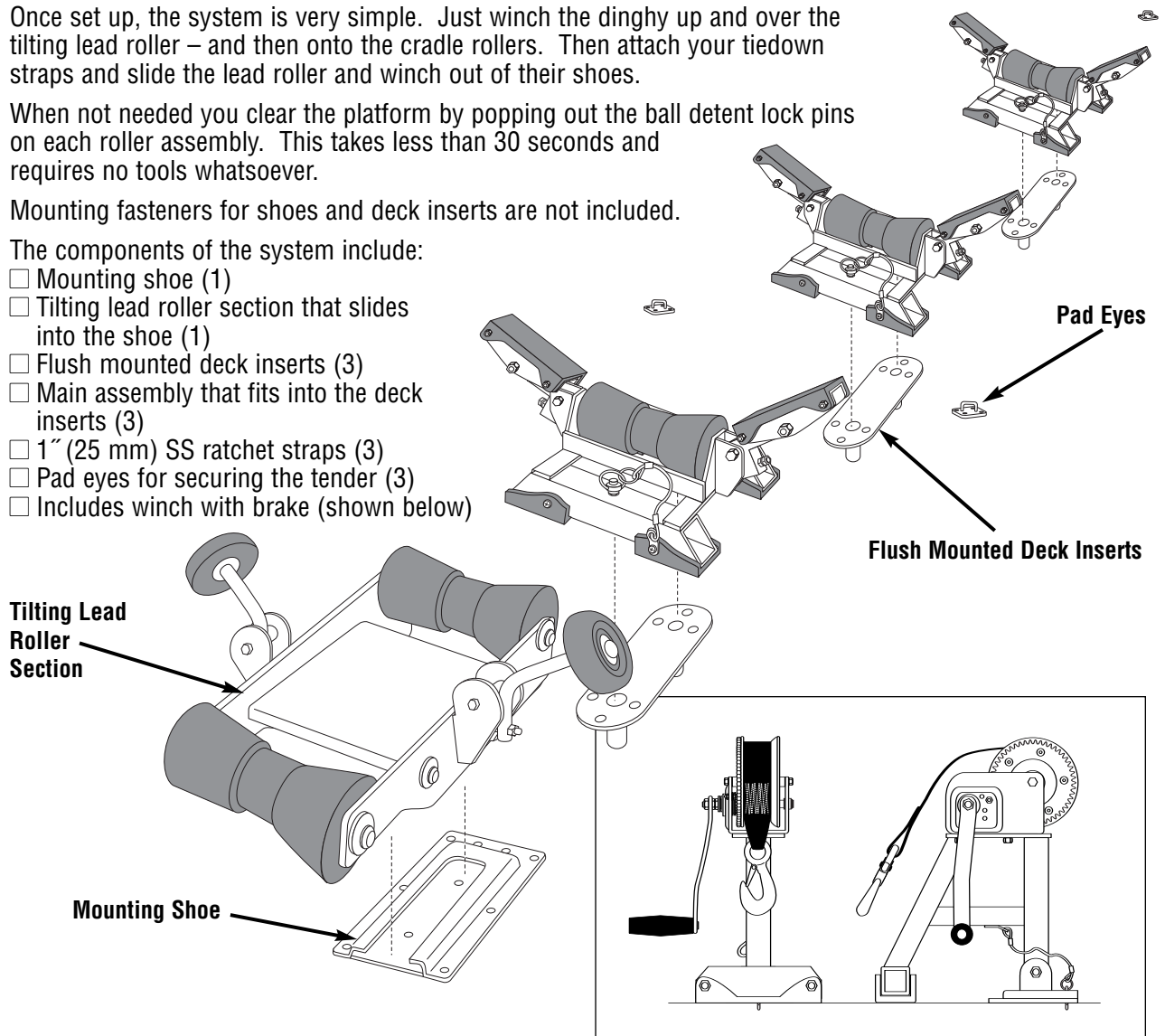

# ST. CROIX ROLL-ON SYSTEM FOR PERSONAL WATERCRAFT



## MODEL 850

Patent #10/306,189

St. Croix Personal Watercraft Roll-On System is designed for yacht owners who demand the best in engineering, function and style. Designed to carry up to 1000 lbs. (454 kg), the stainless steel system can handle almost all PWCs. Once the mounting hardware is installed, the system can be easily mounted or removed as needed. In just moments, without using any tools, your swim platform can be completely clear of obstructions.

Available with manual retrieval or an optional manual winch. The system is Satin glass finished stainless steel. Weighing less than 50 lbs. (23 kg) and taking up less than a cubic foot, it stores easily when not in use.

The components of the system include:

- Mounting shoe (1)
- Tilting lead roller section that slides into the shoe (1)
- Flush mounted deck inserts (2)
- Main assembly that fits into the deck inserts (1)
- 1" (25 mm) SS ratchet straps (3)
- Pad eyes for securing the tender (3)
- Includes winch with brake (shown on previous page)

Optional components include:

- Intermediate roller section

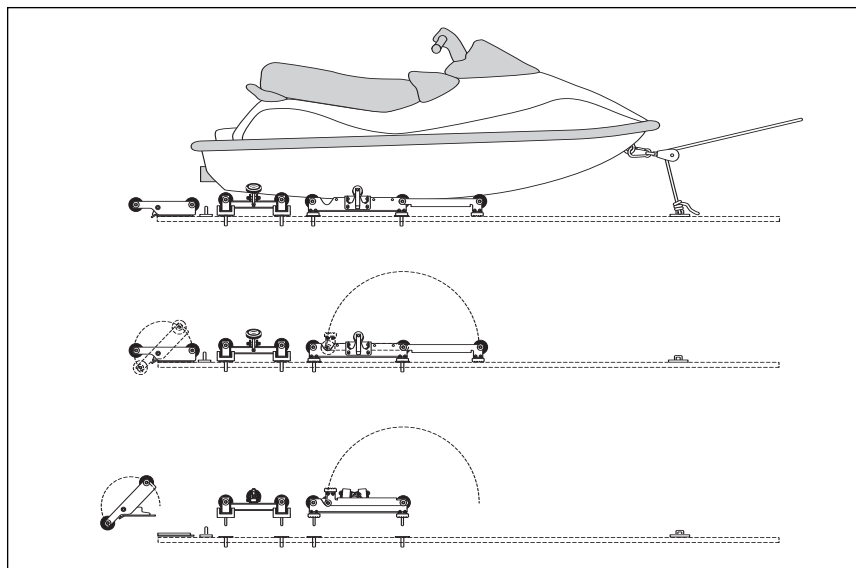
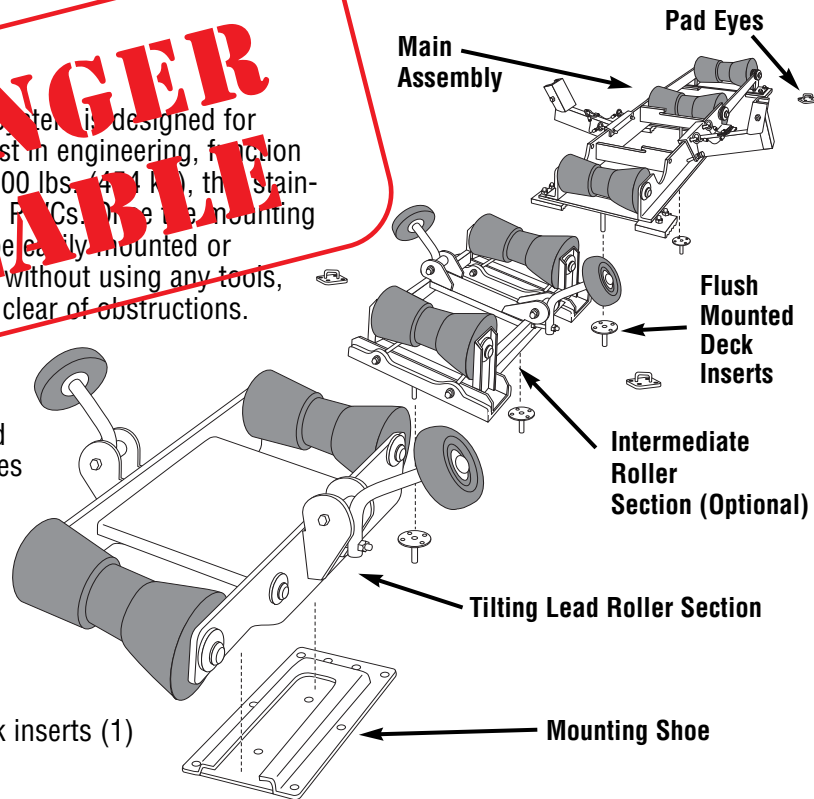



# ST. CROIX LONGBUNK SYSTEM

**MODEL 870**

Patent #10/306,189

**Winch Stand** slides into platform-mounted shoe

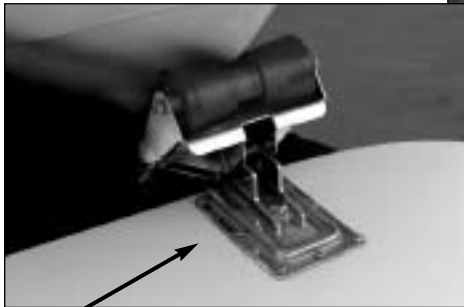

**Lead Roller** slides into platform-mounted shoe

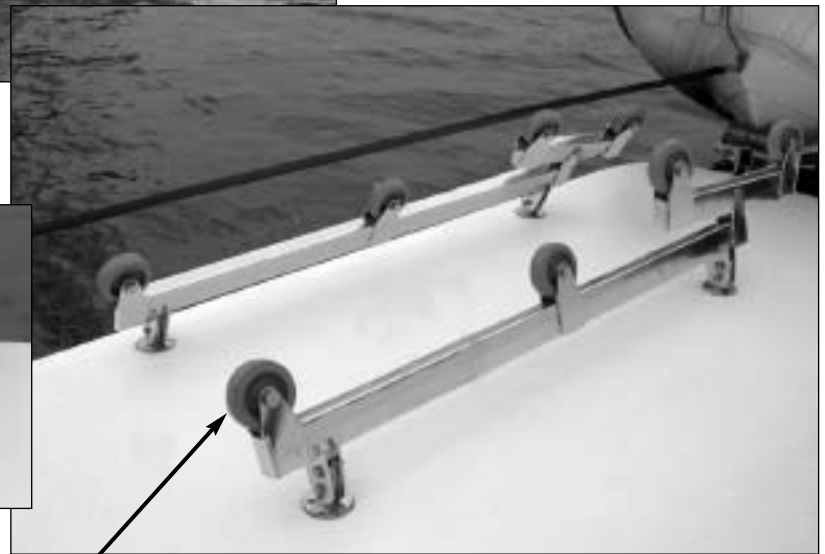

**Maintenance Free Rollers** on 48" (122 cm) long bunks

An elegant solution to swim platform storage that is easy to install and easier to remove! The Long Bunk Roll-On System is engineered with four low-profile receivers that install permanently to the swim platform. Two SS bunks with roller assemblies slide into the receivers. A lead roller slides into a platform mounted shoe. A manual winch stand slides into a platform mounting shoe. Rated for 600 lbs. (272 kg.). The system is engineered using 316 stainless steel components and marine grade material on the lead roller and bunks. The Long Bunk system is designed to be used on any swim platform that is at least 46" (117 cm) deep. Removes in seconds without tools! Slide the bunks out of the receivers and slide the lead roller and winch stand out of the shoes. It's that simple!

The components of the system include:

- 48" (122 cm) Long Bunks (2)
- Lead Roller (1)
- Winch Stand with Winch & Strap (1)
- Permanent Platform Mounting Shoes (2)
- Permanent Platform Mounting Post Receivers (4)
- 1" (25 mm) SS ratchet straps (3)
- Pad eyes for securing the tender (3)

Optional components include:

- 2 - 24" (61 cm) Cantilevered Extension Arms

Optional:

- 64" Bunks

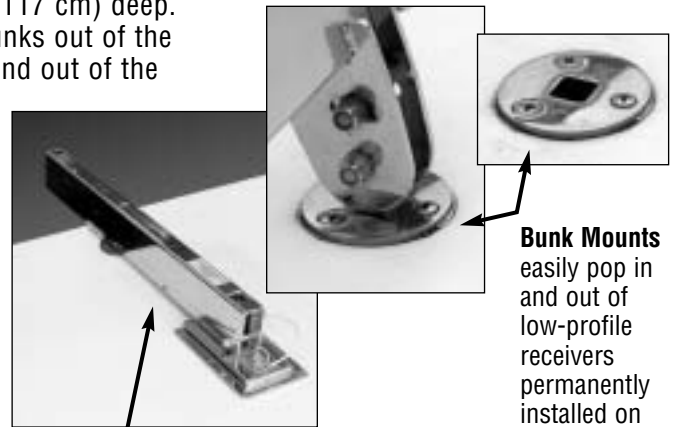

**#874 Extension 20" (50.8 cm)** for narrower platforms.

**Bunk Mounts** easily pop in and out of low-profile receivers permanently installed on platform.



# ST. CROIX TOWBAR SYSTEM

## MODEL 810

Want to tow your dingy or PWC at planing speeds? Take a close look at St. Croix's removable Towbar. This device is easy to attach each time you want to tow. Just slip the winch end into a low-profile shoe which is permanently mounted to the platform. This prepositions the pivot side so it can be held in place with a pair of simple ball lock detent pins. Then hook the winch strap at the bow eye, winch the dinghy tight against the tow roller stops, and you're ready to go. (It's also a good idea to attach stern lines if you know you'll eventually be backing up.) The entire unit is stainless steel for years of trouble-free use. Towing capacity is 1000 lbs. (454 kg.).

**Mounting Position:** On some boats the ideal placement is in the center. On others, it's off to the side. To determine which is right for your boat, just go for a ride and look at your wake while on plane. You want to tow where the water is flattest.



## ST. CROIX FOLDING LADDERS MODEL 103H

This is the best design if you want to board your inflatable from the water with ease and grace! Our ladder is made of 1" (25 mm) tubular, polished stainless steel with 3 steps, handles and is foldable for easy storage. An adjustable lanyard attaches the ladder to an eye bolt in the transom of your inflatable. The ladder design allows use with larger tube inflatables as well as standard tube sizes. Ladder includes an adjustable lanyard for perfect fit and snap hook for easy attachment.

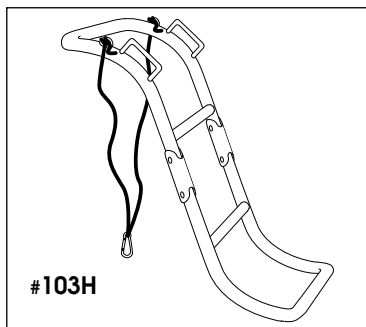

### Dimensions

- Width Overall 13.5" (34 cm)
- Length Extended for Use 38.5" (98 cm)
- Folded Dimensions 20.5" L x 13.5" W x 6.5" D (52 cm x 34 cm x 16.5 cm)

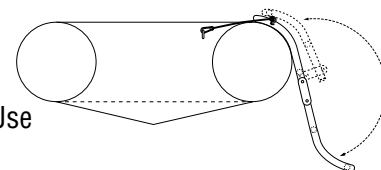

# ST. CROIX DELUXE HELM & SEATING

## Euro Helm Seating Package

Custom design a safe, comfortable seating arrangement for your ribbed inflatable with any combination of our exclusive Euroseating components. All three are ergonomically engineered with stainless steel, marine grade vinyl, and high-density foam. Each features crisp gray stitching and accent trim plus a flip-down back and optimized stowage underneath.

### MODEL 120

EURO Front Single Seat

- Adjustable
- Fits All Ribs
- Complete with 16" x 20" (40.6 x 50.8 cm) Vinyl Seat & Folding Backrest
- Ergonomic Design

### MODEL 121

EURO Front Bench Seat

- Adjustable
- Fits All Ribs
- Complete with 16" x 34" (40.6 x 86.4 cm) Vinyl Seat & Folding Backrest
- Under-seat Storage
- Ergonomic Design

### MODEL 122

EURO Helm Assembly

- Adjustable
- Fits All Ribs
- Complete with 16" x 34" (40.6 x 86.4 cm) Vinyl Seat & Folding Backrest
- Under-seat Storage
- Ergonomic Design
- Uflex Steering with 7' (2.1 m) Cable

### MODEL 123

Standard Bench Seat (Not Shown)

- 13" x 30" (33 cm x 76.2 cm) Vinyl Bench Seat



Helm and Seat fold down for easy storage



Model 121



Model 120

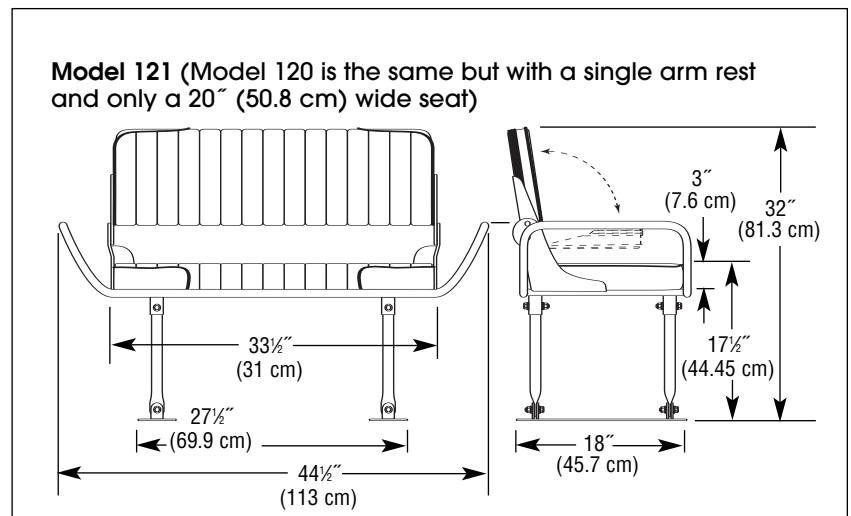

# ST. CROIX REMOVABLE CRANES

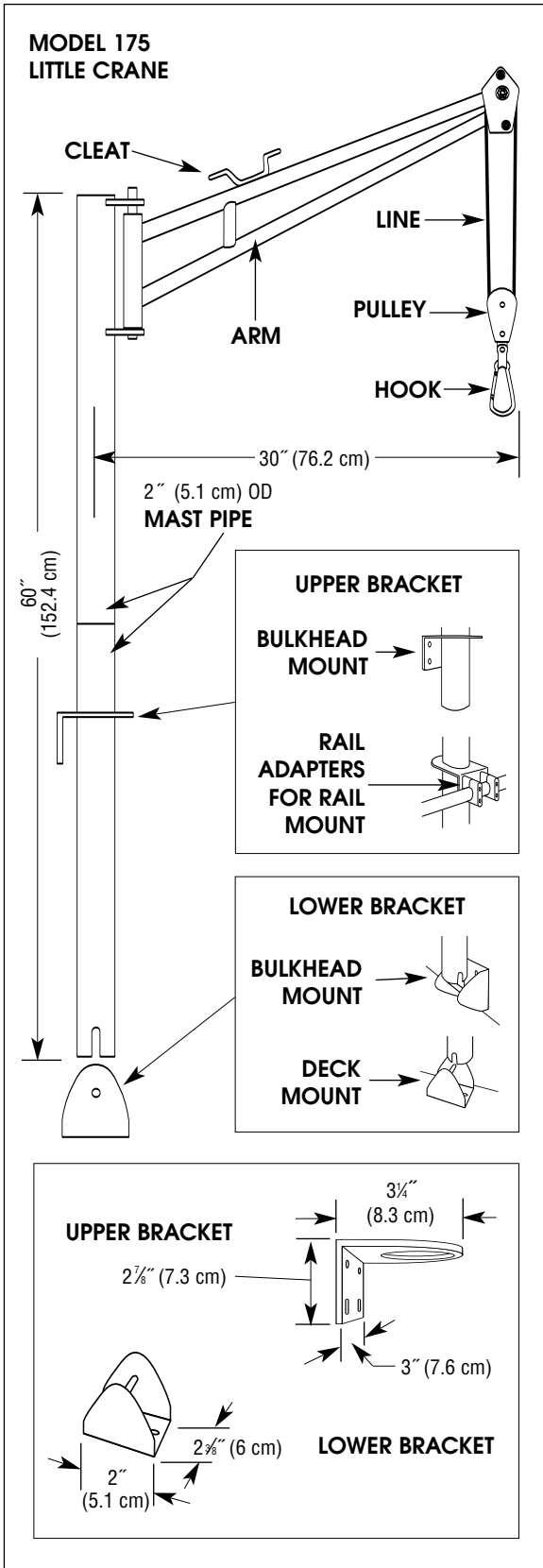

## MODEL 175 LITTLE CRANE

## MODEL 190 JUNIOR CRANE

Precision engineered and fabricated from stainless steel, the removable crane will lift heavy loads with ease. The fixed upper pulley prevents twisted lifting lines while the lower pulley has an integral snap hook for easy attachment to outboards, groceries, sail bags, dive gear, scooters, bicycles or any other type of non-human load. The crane arm rotates 270 degrees. Best of all, it takes just 20 seconds to set up or remove for storage! No Tools Required! Removable cranes are available in two models and come complete for deck, rail or bulkhead mounting. Upper bracket attaches to a rail or a bulkhead while the lower bracket can be mounted on a deck or vertical surface. Each crane consists of the following parts:

- 1 Polished Stainless Steel Mast
- 1 Polished Stainless Steel Arm
- 2 Mounting Brackets (one upper and one lower)
- 2 Adapters for 7/8" (22 mm) or 1" (25 mm) Rails\*
- 1 Pulley
- 1 Snap Hook
- 1 5/16" line

\*Rail adapters for larger rails are available by calling the factory at 952.858.8393.

Specifications for each model are found in the chart below.

Model	#175 Little Crane	#190 Junior Crane
Lifting Capacity	175 lbs (79.2 kg)	200 lbs. (90.5 kg)
Lifting Ratio	7:1	9:1
Arm Reach	30" (76.2 cm)	40" (101.6 cm)
Length of 5/16" Line	75' (22.9 m)	100' (30.5 m)
Mast Height	5' (1.5 m) Two 30" (76.2 cm) sections	5' (1.5 m) One section

*Crane accessories will complete your system, giving you the option to use your crane in different locations and store your outboard safely.*



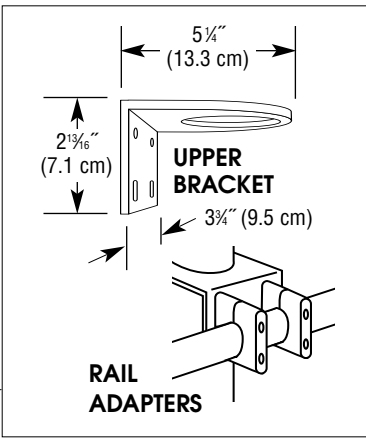
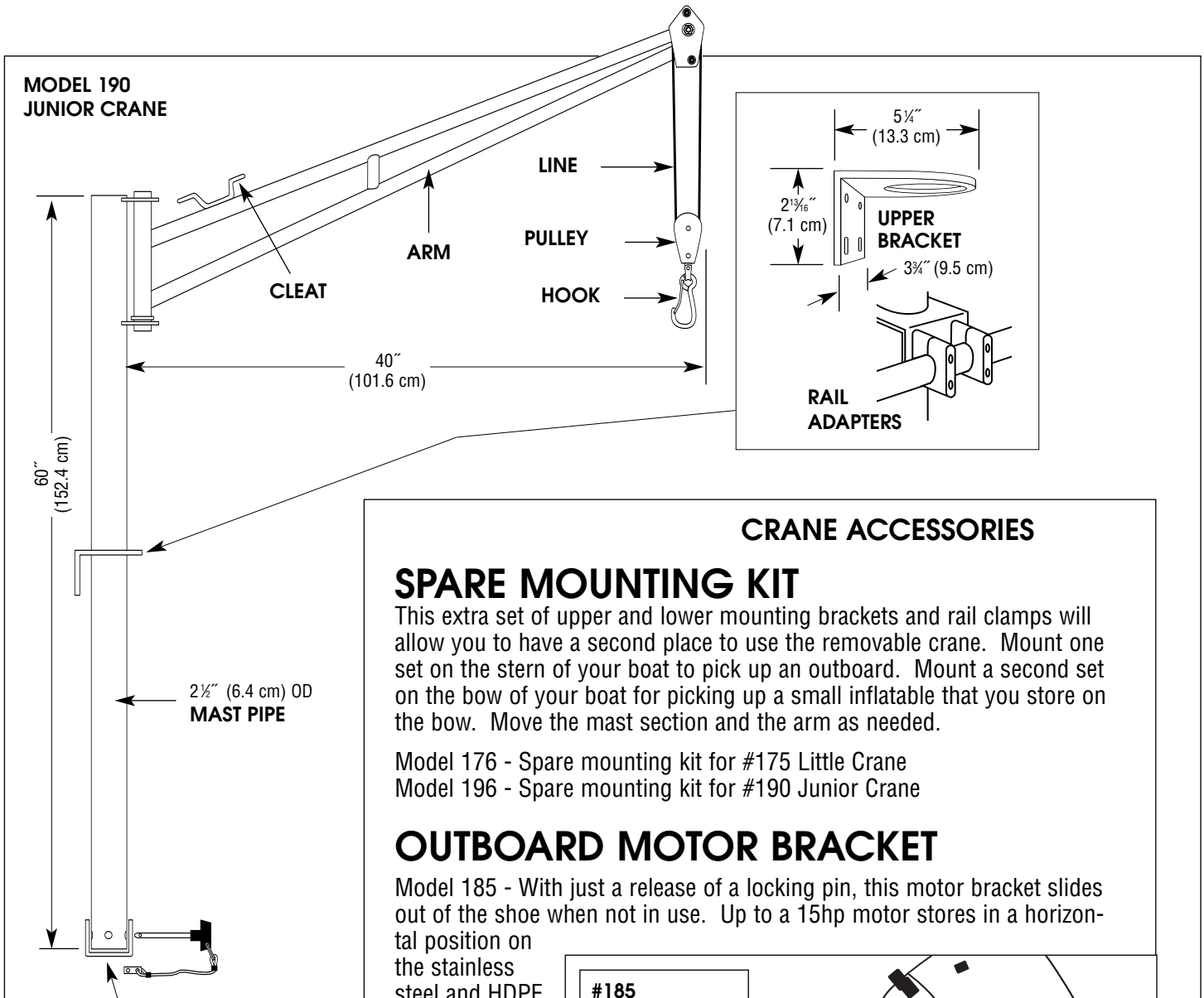

### CRANE ACCESSORIES

## SPARE MOUNTING KIT

This extra set of upper and lower mounting brackets and rail clamps will allow you to have a second place to use the removable crane. Mount one set on the stern of your boat to pick up an outboard. Mount a second set on the bow of your boat for picking up a small inflatable that you store on the bow. Move the mast section and the arm as needed.

Model 176 - Spare mounting kit for #175 Little Crane  
 Model 196 - Spare mounting kit for #190 Junior Crane

## OUTBOARD MOTOR BRACKET

Model 185 - With just a release of a locking pin, this motor bracket slides out of the shoe when not in use. Up to a 15hp motor stores in a horizontal position on the stainless steel and HDPE bracket. Height is 12 5/16" (31.3 cm). Mounting shoe dimensions are 4 5/8" (11.7cm) x 7 1/8" (18.1cm). It's usable and removable!

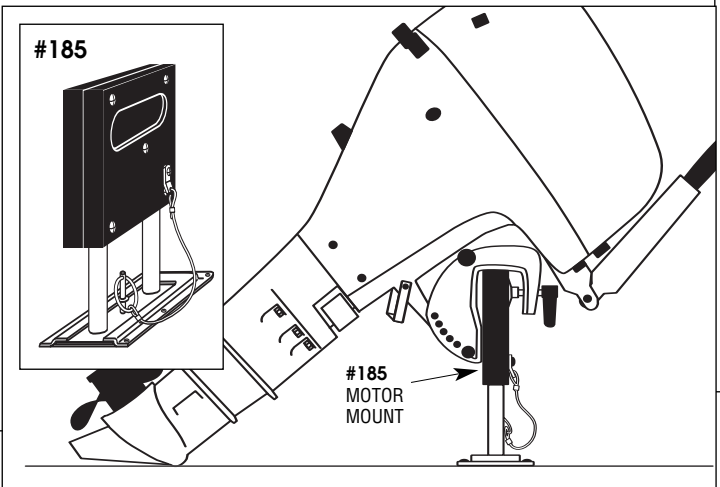
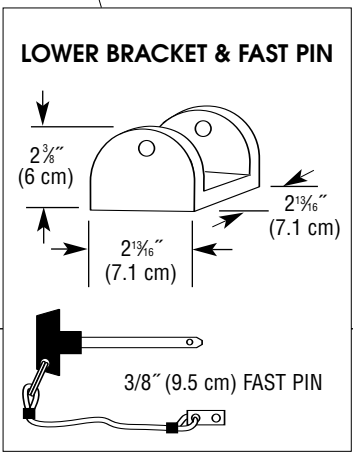

St. Croix Marine Products  
 3900 Dight Avenue South  
 Minneapolis, MN 55406  
 U.S.A.



Tel: 612-724-9361  
 Fax: 612-724-9362  
 E-Mail: stcroix@davit.com  
 www.davit.com