

HINGED TOP SLIDE

316 STAINLESS STEEL

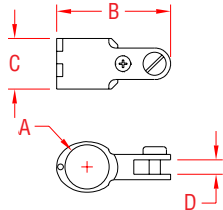

ITEM

A

B

C

D

WT

(size)

(lb)

S3683-0000

7/8"

2.24"

1.00"

0.30"

0.15

S3683-0001

1"

2.37"

1.00"

0.30"

0.16

NOTE:

VERY SLEEK DESIGN WITH INCORPORATED HINGE (NOT 2 PARTS) WHICH PREVENTS LOSS DURING INSTALLATION; ALLOWS EASY INSTALLATION OF A TOP SLIDE ON ANY EXISTING BIMINI TOP.

