

## Air Top 2000 STC

Air Heater (Gasoline and Diesel)



### Air Heater Features:

- Provides rapid cab/compartment heat without idling
- Warm work area ideal for driver and storage (tools, cargo, etc.)
- High heat output in a compact design
- Quiet operation
- Reduced emissions = cleaner work environment
- Full diagnostics with PC interface available
- Low fuel consumption
- Proven quality & reliable performance
- Fast Return on Investment

### Cab and compartment heating, fuel savings and emissions reduction

The Air Top 2000 STC is the most popular choice in idle reduction technology. Millions are being used in various applications around the world. Perfect for cab/compartment heating, the Air Top 2000 STC gets the job done with 7,000 BTU/h (2 kW) of heat output. This compact unit is low on maintenance, service-friendly and the most efficient air heater on the market. The Air Top 2000 STC can pay for itself within months.

## Technical Specifications

	Air Top 2000 STC
Heating Capacity	3,100 – 7,000 BTU/h (0.9 – 2.0 kW)
Fuel	Diesel, Gasoline
Fuel Consumption	0.03 – 0.06 gal/h (0.12 – 0.24 l/h)
Rated Voltage	Gasoline- 12 V , Diesel- 12 or 24 V
Operating Voltage Range	10.5 - 16 V or 21 - 32 V
Power Consumption	14 – 29 Watts
Air Flow	55 cfm (93 m <sup>3</sup> /h)
Dimensions (L x W x H)	12.25 x 4.78 x 4.85 in (311 x 120 x 121 mm)
Weight	5.73 lbs (2.6 kg)

### Available Air Top 2000 STC Heater Kits:

Air Top 2000 STC Diesel Kit with Rheostat (12 V) - P/N: 5012550A

Air Top 2000 STC Diesel Kit with Rheostat (24 V) - P/N: 5012553A

Air Top 2000 STC Diesel Kit with SmarTemp 2.0 (12 V) - P/N: 5012555A

Air Top 2000 STC Gasoline Kit with Rheostat (12 V) - P/N: 5012558B

### Standard Kit Components:

- Integrated Control Unit
- On/Off Switch with Variable Temperature Control
- Fuel Metering Pump w/Mounting Bracket
- Fuel Line and Fuel Filter
- Universal Fuel Standpipe
- Heater Mounting Bracket w/Gasket
- Wiring Harness w/Fuse Holder
- Exhaust Tubing
- Combustion Air Tubing and Heater Ducting
- Air Inlet/Outlet Vent
- Operation/Installation Manual
- 2 Year/2000 Hour Limited Warranty

### Optional Accessories:

#### ■ SmarTemp Control 2.0 (unit only)

(Diesel Kits only):

Part Number 5010624C

#### ■ SmarTemp Control 2.0 Unit Retrofit Kit with adapter harness

(Diesel Kits only):

Part Number 5010628C



- Programmable heater start time
- Ergonomical design
- Large backlit LCD screen
- Ambient temperature display

#### ■ Ducting Kit

(Gas Kits only):

Part Number 5013413A



## System Schematic

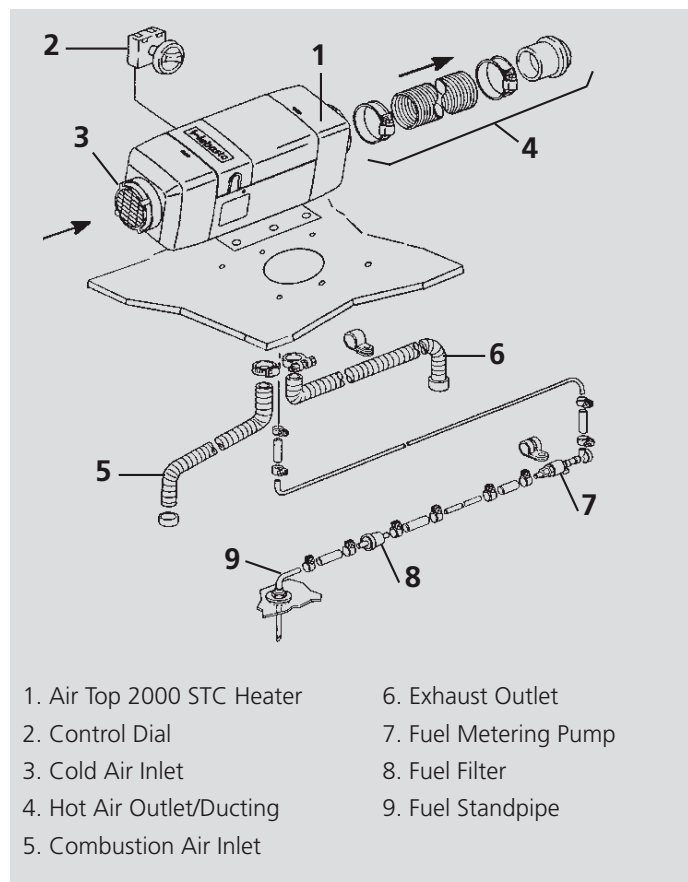

- |                            |                       |
|----------------------------|-----------------------|
| 1. Air Top 2000 STC Heater | 6. Exhaust Outlet     |
| 2. Control Dial            | 7. Fuel Metering Pump |
| 3. Cold Air Inlet          | 8. Fuel Filter        |
| 4. Hot Air Outlet/Ducting  | 9. Fuel Standpipe     |
| 5. Combustion Air Inlet    |                       |

Webasto Thermo & Comfort  
North America, Inc.

15083 North Road  
Fenton, Michigan 48430  
USA

Toll Free: 800-860-7866  
Phone: 810-593-6000

[webasto.com](http://webasto.com)