

PLANT VIEW  
VISTA SUPERIOR

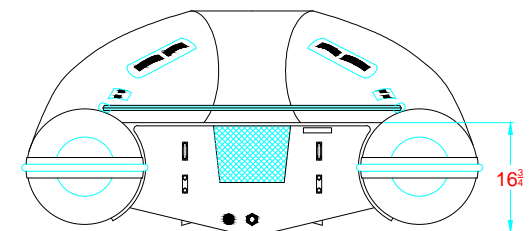

AFT VIEW  
VISTA TRASERA

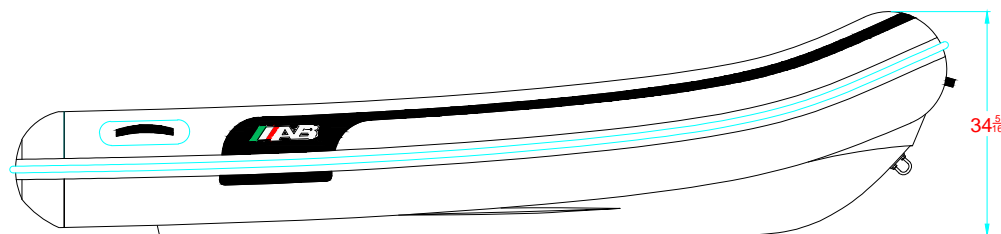

LONGITUDINAL PROFILE  
VISTA LATERAL

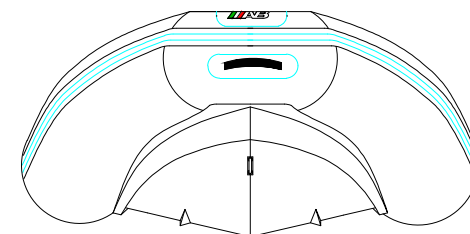

FORE VIEW  
VISTA FRONTAL

MAIN PARTICULARS

MAXIMUM LENGTH/ESLORA MAX. \_\_\_\_\_ 12' (3.66m)  
 MAXIMUM BEAM/MANGA MAX. \_\_\_\_\_ 6' (1.82m)

NOTES: 1.-ALL DIMENSIONS IN INCHES  
 TODAS LAS MEDIDAS ESTAN DADAS EN PULGADAS

		TITLE: "NAVIGO 12 VS "						
		GENERAL ARRANGEMENT ARREGLO GENERAL						
SUBJECTED: ALEXANDER BARRIOS		SCALE:	SHEET: 1/1	CODE:	PLAN:	No.REV 5	DATE 09.01.19	DRAWN HECTOR SUAREZ
APPROVED: HERMES GARCIA							DATE	APPROVED:

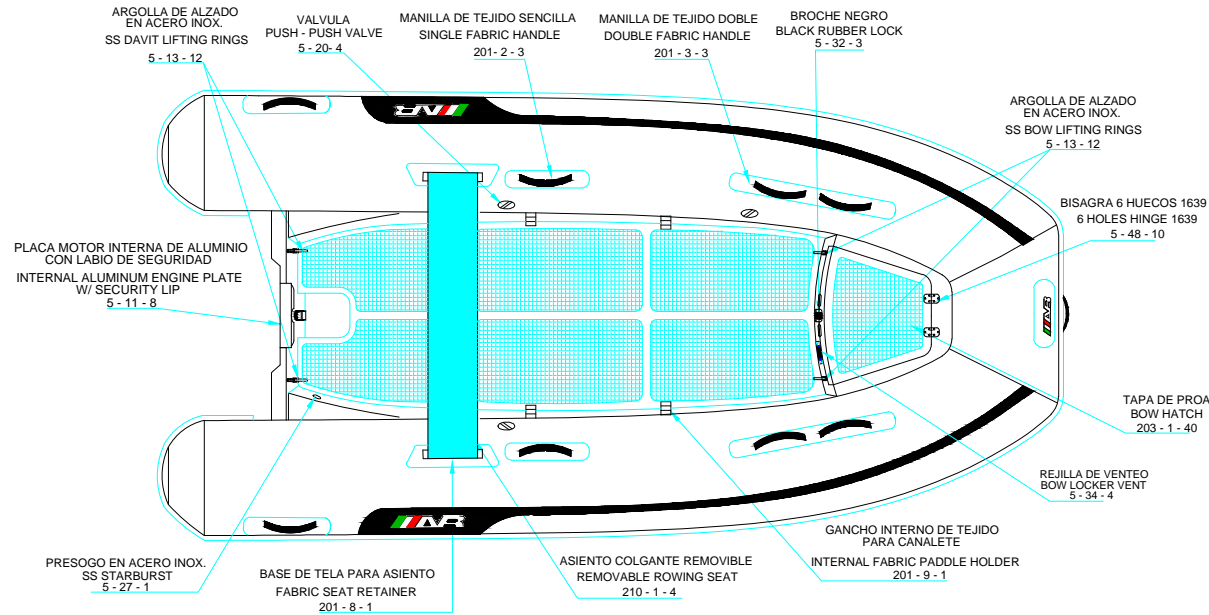

PLANT VIEW  
VISTA SUPERIOR

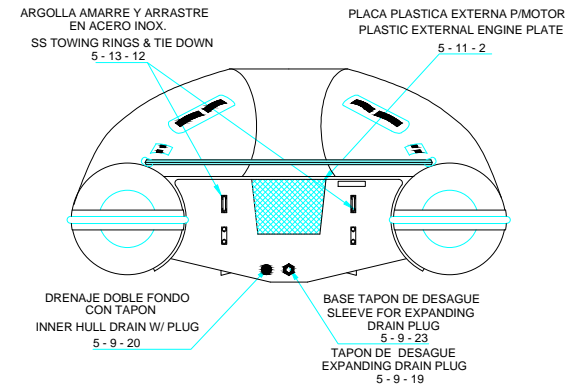

AFT VIEW  
VISTA TRASERA

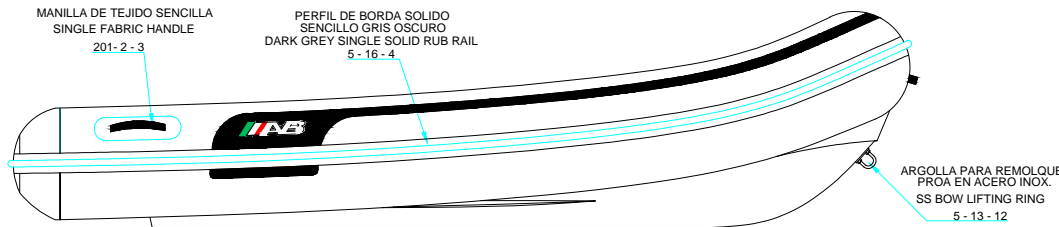

LONGITUDINAL PROFILE  
VISTA LATERAL

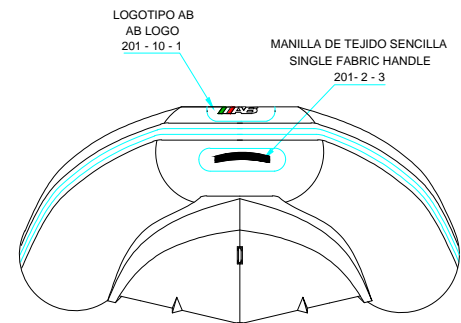

FORE VIEW  
VISTA FRONTAL

NOTA: FAVOR INDICAR COLOR DEL BOTE AL ORDENAR / NOTE: MUST INDICATE BOAT COLOR WHEN ORDERING

REV. 5

# NAVIGO 12 VS

315 - 2 - 4

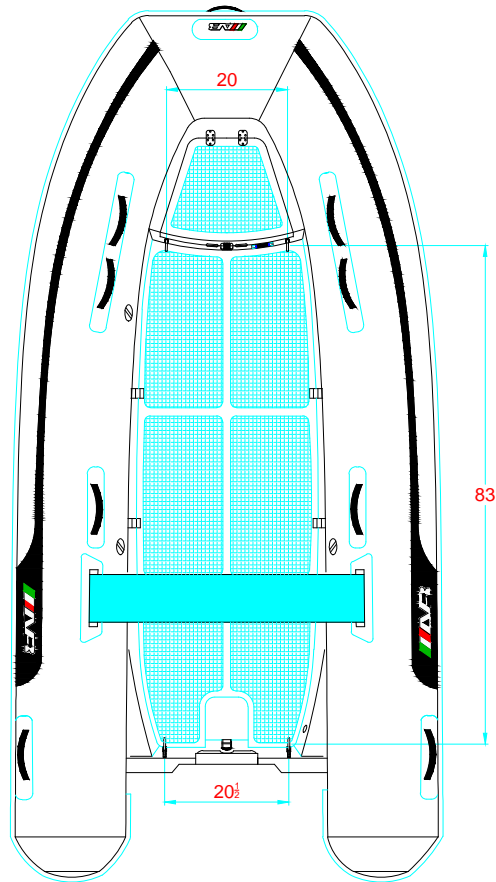

-LOCATION AND DISTANCE  
OF DAVIT LIFTING POINTS

UBICACION Y DISTANCIA  
DE LOS GANCHOS DE IZADO

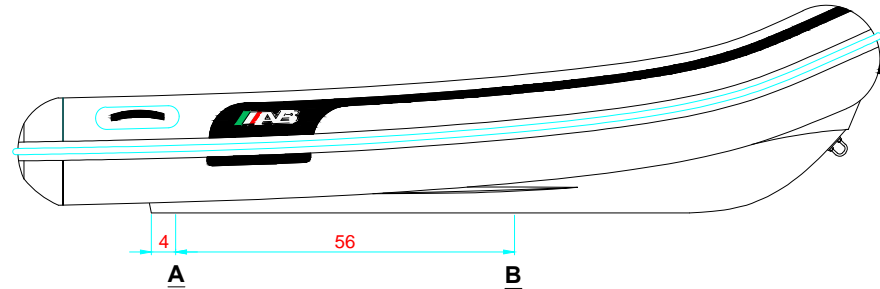

LONGITUDINAL PROFILE  
VISTA LATERAL

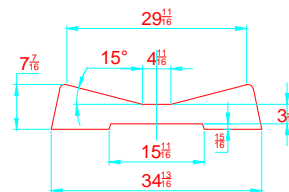

TRANSVERSAL SECTION "A"  
SECCION TRANSVERSAL "A"

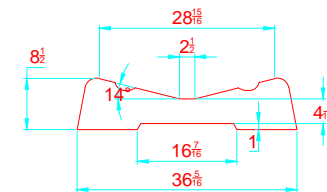

TRANSVERSAL SECTION "B"  
SECCION TRANSVERSAL "B"

-RECOMMENDED CHOCK LOCATION AND BUILDING DIMENSIONS  
UBICACION DE LAS CUNAS Y SUS MEDIDAS DE FABRICACION

-VERIFY MEASUREMENTS WITH ACTUAL HULL  
VERIFICAR MEDIDAS DE ACUERDO A CASCO ACTUAL

NOTES: 1.- ALL DIMENSIONS IN INCHES  
2.- MEASURES FROM CENTER OF CHOCK'S SURFACES